

### WIRING DIAGRAM

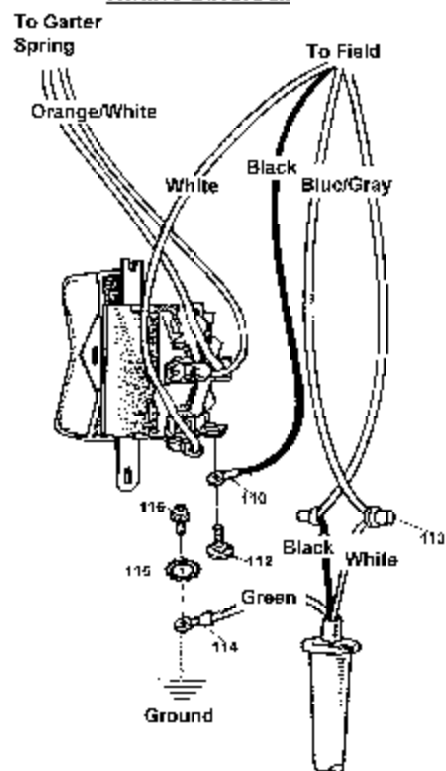

| Item No. | Part No.        | No. Used | Description                                     | Item No.           | Part No.        | No. Used | Description                                 |
|----------|-----------------|----------|---|--------------------|-----------------|----------|---|
| 1        | 421120-1        | 1        | Bumper  | 40                 | <b>181047-4</b> | 2        | CarbonBrush CB-154 (2pcs/Set)               |
| 2        | 156135-6        | 1        | Hammer Case (Includes Items 53 & 54)            |                    | 181048-2        | 2        | Auto Cut-Off Carbon Brush CB-155 (Optional) |
| 3        | 253909-7        | 1        | Flat Washer 35                                  |                    |                 |          |   |
| 4        | 231921-7        | 1        | Ring Spring 22 (Type 2) *                       | 41                 | 643650-4        | 2        | Brush Holder Cap 6.5-13.5                   |
| 5        | *               | 1        | Anvil   | 42                 | 341367-0        | 2        | Brush Holder Cap Cover                      |
| 6        | 253182-9        | 1        | Flat Washer 36                                  | 43                 | 911121-2        | 2        | P.H. Screw M4X14                            |
| 7        | 221815-4        | 1        | Internal Gear 82                                | 44                 | 682505-8        | 1        | Cord Guard 10-90                            |
| 8        | 256051-3        | 2        | Pin 10  | 45                 | 664820-2        | 1        | Cord With Plug 3P-14-2.5                    |
| 9        | 212063-6        | 2        | Needle Bearing 1012                             | 46                 | 687600-9        | 1        | Strain Relief                               |
| 10       | 221816-2        | 2        | Spur Gear 37                                    | 47                 | 911116-5        | 2        | P.H. Screw M4X12                            |
| 11       | 325416-1        | 1        | Spindle   | 48                 | 911106-8        | 1        | P.H. Screw M4X8                             |
| 12       | 216010-9        | 2        | Steel Ball 10.3                                 | 49                 | 651554-6        | 1        | Switch                                      |
| 13       | 253713-4        | 1        | Flat Washer 35                                  | 50                 | 312742-7        | 1        | Handle Cover                                |
| 14       | 333112-7        | 1        | Ring 79   | 51                 | 911146-6        | 2        | P.H. Screw M4X25                            |
| 15       | 231211-8        | 1        | Compression Spring 36                           | 52                 | 654502-4        | 2        | Solderless Connector P-2                    |
| 16       | 231212-6        | 1        | Compression Spring 49                           | 53                 | <b>213456-0</b> | 1        | Oil Seal 35                                 |
| 17       | 253712-6        | 1        | Flat Washer 36                                  | 54                 | <b>257536-2</b> | 1        | Sleeve 35                                   |
| 18       | 216002-8        | 32       | Steel Ball 4.8                                  | 55                 | <b>643653-8</b> | 2        | Brush Holder 6.5-13.5                       |
| 19       | 325415-3        | 1        | Hammer  | 56                 | <b>913206-0</b> | 2        | Set Screw M5X8                              |
| 20       | 211451-4        | 1        | Ball Bearing 6007LLB                            | 57                 | <b>951104-0</b> | 1        | Spring Pin 4-12                             |
| 21       | 256040-8        | 2        | Pin 5   | 60                 | 325365-2        | 1        | Pin (Type 1) *                              |
| 22       | 312739-6        | 1        | Bearing Housing                                 | 61                 | 231213-4        | 1        | Spring (Type 1) *                           |
| 23       | 211217-2        | 1        | Ball Bearing 1511LLB                            | 62                 | 256710-9        | 1        | Slotted Pin (Type 1) *                      |
| 24       | 241613-0        | 1        | Fan 90  | 100                | 273444-9        | 1        | Grip 37                                     |
| 25       | 613282-1        | 1        | Armature Assy (Includes Items 23, 24, 38 & 39)  | 102                | 923456-9        | 1        | Cap Square Neck Bolt M8X35                  |
| 26       | <b>265343-9</b> | 2        | (+) Hex Bolt M5X80 (With Spring Washer & Glued) | 103                | 345097-5        | 1        | Belt  |
| 27       | 413009-7        | 1        | Baffle Plate                                    | 110                | 654037-5        | 4        | Insulated Eye Terminal FV1.25-M3            |
| 28       | 623252-2        | 1        | Field (With Items 30 & 52)                      | 112                | 652008-6        | 4        | P.H. Screw M3.5X7(With Washer)              |
| 29       | 953106-2        | 4        | Rivet 0-5                                       | 113                | 654510-5        | 2        | Closed End Connector 5.5-SD                 |
| 30       | 654020-2        | 2        | Garter Spring                                   | 114                | 654005-8        | 1        | Solderless Eye Terminal 2-M4                |
| 31       | 942151-2        | 4        | Spring Washer 6                                 | 115                | 943053-5        | 1        | Toothed Lock Washer 4                       |
| 32       | 922382-9        | 4        | Hex Socket Head Bolt M6X60                      | 116                | 652012-5        | 1        | P.H. Screw M4X8                             |
| 33       | 156136-4        | 1        | Motor Housing (With Items 55 - 57)              | <b>Accessories</b> |                 |          |   |
| 34       | 681002-1        | 2        | Insulation Washer                               | A01                | 123018-5        | 1        | Side Handle Assy (Includes 100, 102 & 103)  |
| 35       | 911216-1        | 2        | P.H. Screw M5X14                                | A02                | <b>134870-6</b> | 1        | Extension Bar 25.4 (Type 2) (Old 785209-2)  |
| 36       | 284016-5        | 1        | Rear Cover                                      | A03                | 783203-8        | 1        | Hex Wrench 5                                |
| 37       | 421075-0        | 1        | Cushion Ring                                    | A04                | <b>182363-7</b> | 1        | Metal Carrying Case                         |
| 38       | 211066-7        | 1        | Ball Bearing 6200LLB                            |                    |                 |          |   |
| 39       | 213051-6        | 1        | Dust Seal 10                                    |                    |                 |          |   |

**SERVICE CHANGES**

**1. Change on Anvil.**

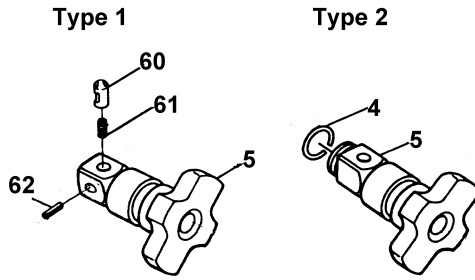

| Item No. | Description    | Type 1                         | Type 2           |
|----------|----------------|--------------------------------|------------------|
| 4        | Ring Spring 22 | -----                          | 231921-7 (Added) |
| 5        | Anvil          | 325414-5 (No Longer Available) | 325587-4         |
| 60       | Pin            | 325365-2 (No Longer Available) | (Discontinued)   |
| 61       | Spring         | 231213-4 (No Longer Available) | (Discontinued)   |
| 62       | Slotting Pin   | 256710-9 (No Longer Available) | (Discontinued)   |

Above parts are completely interchangeable as a set.

When replacing Type 1 Anvil, replace it with complete set of Type 2 parts.