

Satisfy Professional's Needs



7-1/4" Hypoid Saw
5477NB

TOUGH & MUSCULAR



Max. bevel capacity 51.5 degrees.



**Powerful
15AMP
Motor**

Hex wrench holder



Ergonomic top and rear handles positioned, angled, and contoured for best fitting and easy handling

Handle can be replaced without replacing Motor housing.

Non-skid elastomer grip provides more control and comfort.

Easy-to-read cutting depth scale

with the two most common depths, 19 mm (3/4") and 13 mm (1/2"), printed in large type.



Safety Cover Designed to move smoothly.

Scale with easy-to-read calibrations



Easy to replace the Base because the Base is attached by screws.

Positive stopper for 45 bevel cut

Notches to align with cutting line for bevel angle 0 degrees and 45 degrees

Practical Blade Fastening Bolt

Can be tightened/ loosened with either socket wrench or hex wrench.

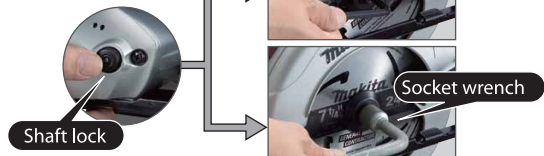

Max. cutting depth
2-3/8"
(60 mm)

Greater than competing models available in the market



Max. bevel capacity
51.5degrees

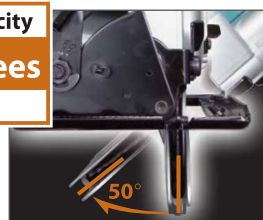

Positive stop
45 degrees

Bevel adjustment with positive stop at 45 degrees.



7-1/4" Hypoid Saw

5477NB 7-1/4" (185 mm)

153 mm

Double insulation



Blade Diameter	7-1/4" (185 mm)
Arbor	5/8" (15.88 mm)
Maximum Cutting Capacities	at 0 degrees: 2-3/8" (60 mm) at 45 degrees: 1-3/4" (44 mm) at 50 degrees: 1-9/16" (40 mm)
No Load Speed	4,500 RPM
AMPS (120V)	15.0 A
Overall Length	17-3/8" (442 mm)

When QUALITY & SERVICE COUNTS – Choose Makita

makita.ca