



Generator Wheel Kit 110004-B

Assembly Instructions

(for generator models G2800I, G4300N, G6100R & G6101R)

WARNING

Read and follow all cautions, warnings and instructions in the Generator or Water Pump Instruction Manual before assembling wheel kits or performing any work or maintenance on your generator or water pump. Failure to do so could result in property damage, serious personal injury or death.

Assembly Instructions; (G2800I, G4300N, G6100R, G6101R)

1. Switch engine off.
2. Be sure that all gasoline has been drained from fuel tank.
3. Remove component parts from box and ensure that all are accounted for (refer to component breakdown on p. 2).
4. Using 5/16"-18x3/4" bolts (#3), 5/16"-18 Nylon Nuts (#4) and 5/16" ID Steel Washer (#5), attach Axle Brackets (#20) to bottom cross plate of the generator frame. (Ref. to Illustration 1.4)
5. Insert Axle (#8) through brackets.
6. On each end of the axle, insert Plastic Tubing (#15), 5/8" I.D. Washers (#9) and Wheel (#11). Push Cotter Pins (#10) through the holes at the end of the axle and bend to secure. If the holes are not visible, the Plastic Tubing (#15) may be trimmed to provide a better fit. Note that the Tubing must be tight against the frame of the generator and the bolts used to tighten the axle bracket may need to be loosened to allow this.

** If tires have become deflated during shipment, please inflate to 30 psi before mounting.**

7. Raise and support the engine end of the generator to install handles (#6). Fit the cradle portion of the handles against the bottom of the generator frame. Use the long Handle Clamp (#19), 5/16" I.D. Washer (#5) and 1-3/4" Hex Bolts (#22) to secure Handle to frame. One Long Handle Clamp should be placed at both the top and bottom on the handle. Refer to Illustration 1.1 & 1.2.

If installing the wheel kit on generator G2800I, refer to step #8.

8. Install Long Handle Clamp on handle, as near to the top of the frame as possible. Use the G2800I Spacer Bracket (#21) to attach the handle to the bottom of the frame as in step #7. Refer to Illustration 1.3.

Wheel Kit Components

Ref. No.	Part No.	Description	Qty
1	110004-4G1	Handle / Frame Clamp Bracket	4
2	110004-4G2	Handle / Frame Clamp Plate	4
3	110004-4G3	5/16"-18 x 3/4" Hex Head Bolt	8
4	110004-4G4	5/16-18 Nylon Nut	12
5	110004-4G5	5/16" ID Steel Washer	12
6	110004-4G6	Handle	2
8	110004-4G8	Axle	1
9	110004-4G9	5/8" ID Washer	2
10	110004-4G10	Cotter Pin	2
11	110004-4G11	Wheel / Tubeless Tire	2
12	110004-4G12	Handle Grip	2
14	110004-4G14	3/4" ID x 1" Thin Wall Hose	4
15	110004-4G15	1/2" ID x 1-1/2" Plastic Tube	2
18	110004-4G18	Handle Clamp Short	4
19	110004-4G19	Handle Clamp Long	4
20	110004-4B01	Axle Bracket	2
21	110004-4S01	Handle Spacer for G2800I	2
22	110004-4HB1	5/16"-18 x 1-3/4" Hex Head Bolts	4

(Please note that extra parts may be included in this kit to enable further customization of the wheel kit. These instructions refer to standard assembly only)

If you are missing any parts, please contact the Makita dealer from whom the kit was purchased for information.

Parts Quick Reference



20 Axle Bracket

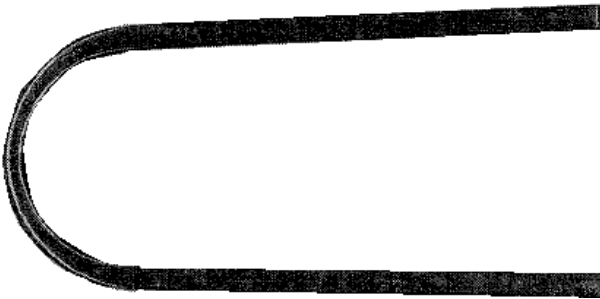

#19 Handle Clamp Long

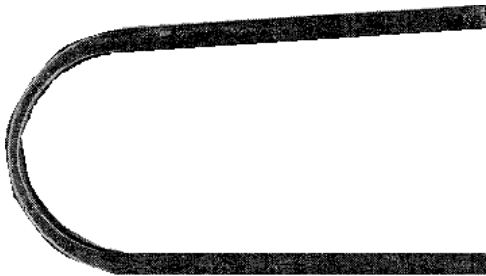

#18 Handle Clamp Short



#22 5/16"-18 x 1-3/4" Hex Head Bolt



#3 5/16"-18 x 3/4" Hex Head Bolt

Illustration 1.2 - Frame and Handle Assembly

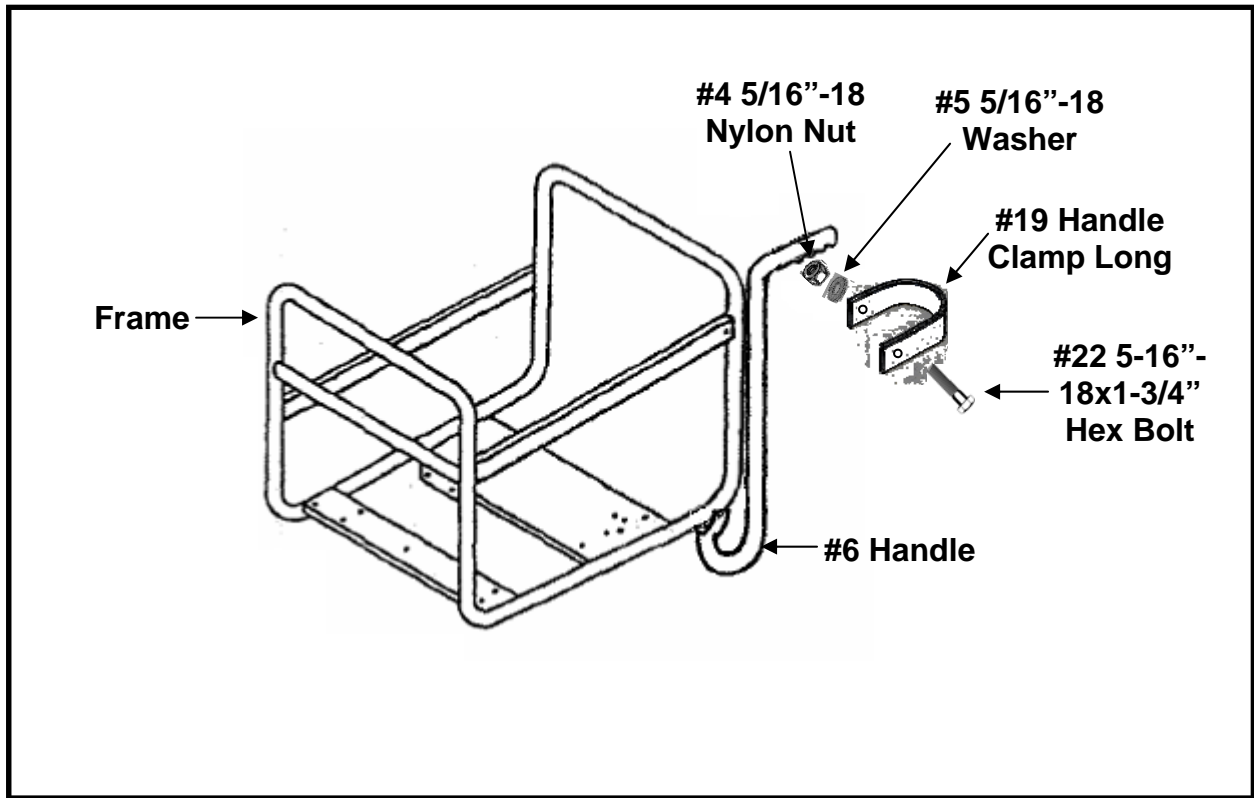

Illustration 1.1 - Frame and Handle Assembly

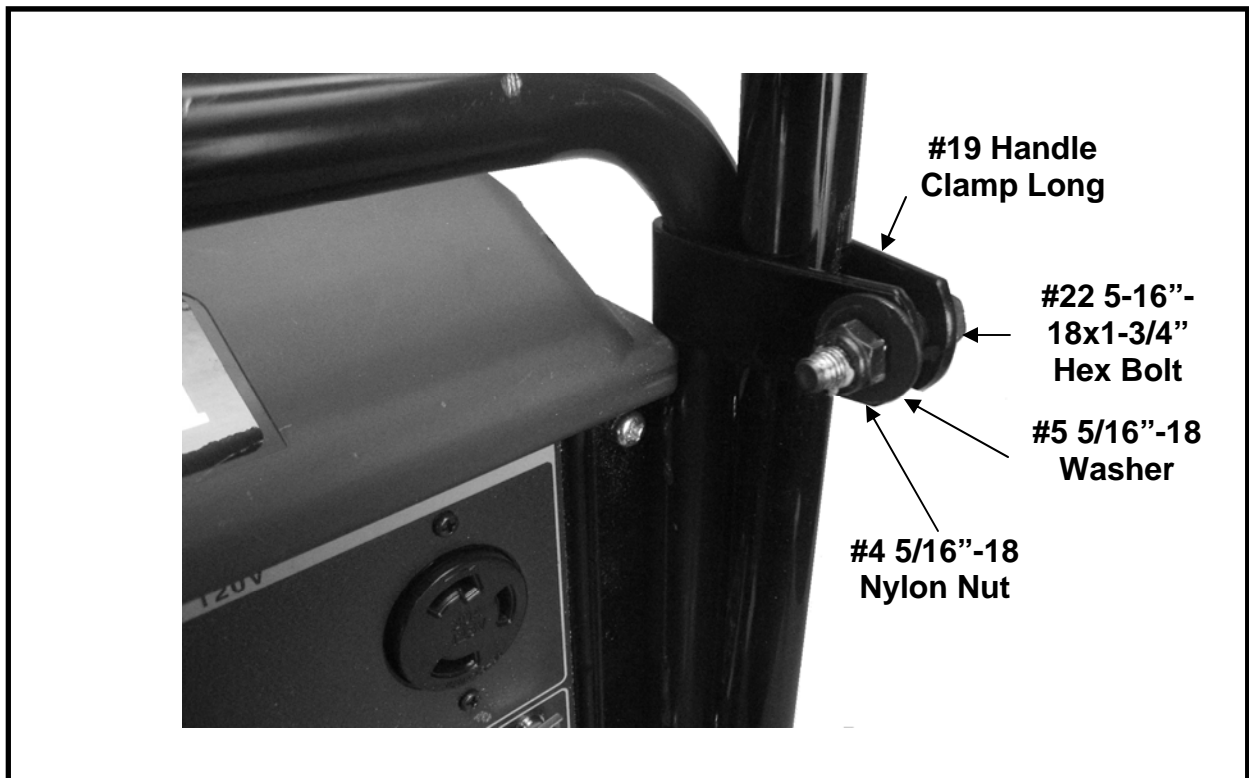

Illustration 1.3 - Detail of G2800I Bracket Assembly

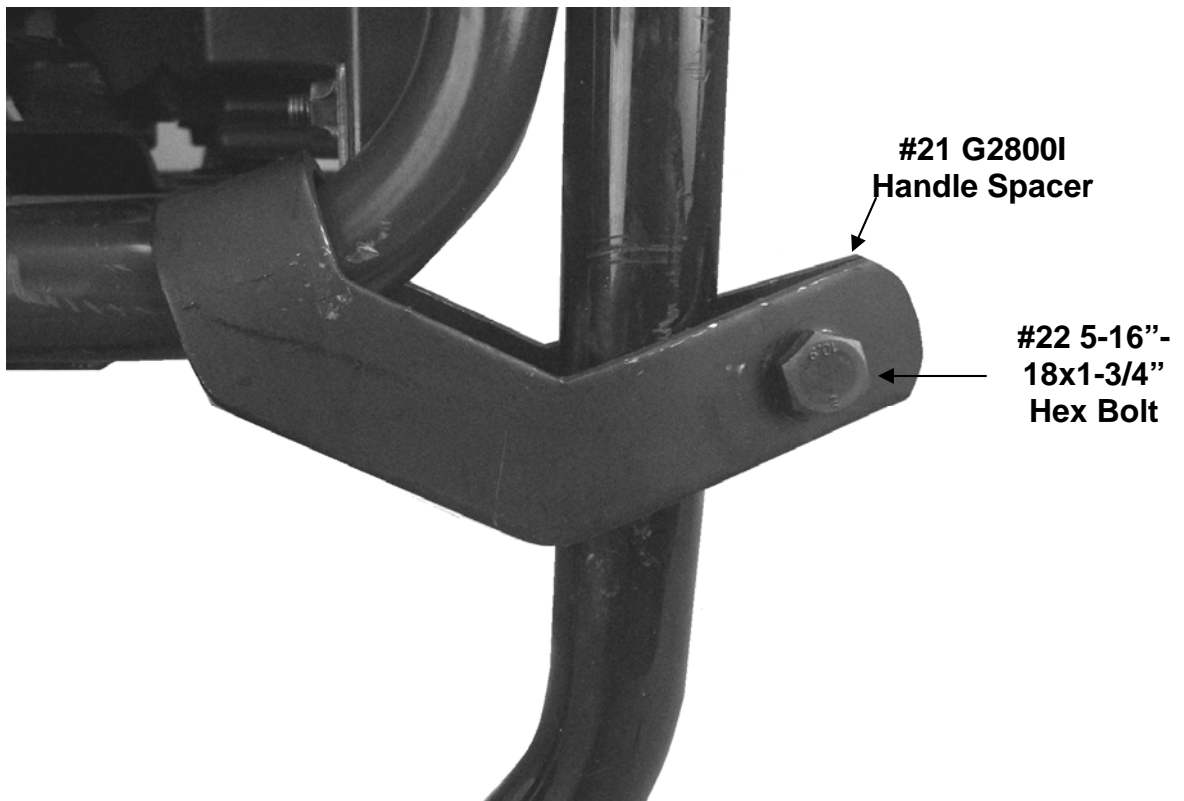
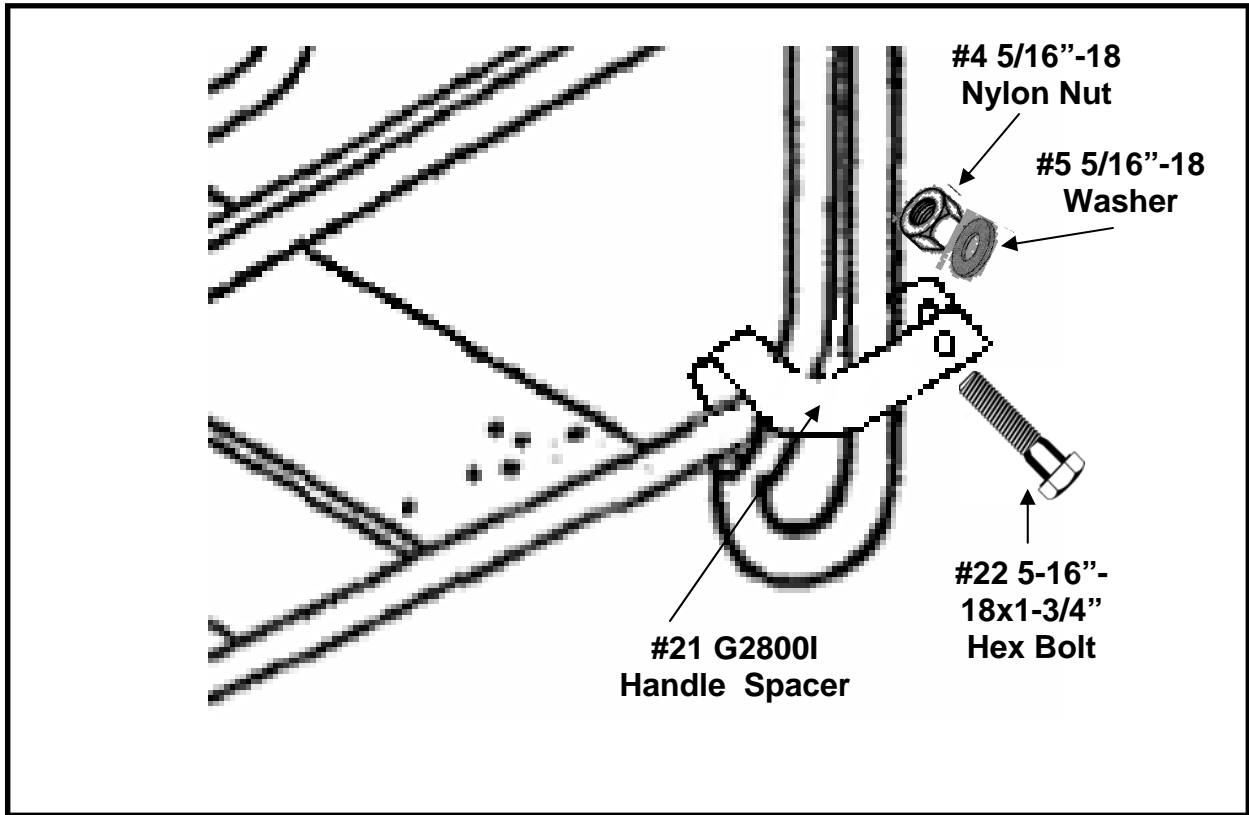

Illustration 1.4 - Wheel and Axle Assembly

